

M3 MOBILE











Mobile Computer

SM 25/24

Accessories Guide



SM25/24 ACC. MAP

Cradle	Power Supply	Pocket Cradle	Boot	ETC
<p>2 SLOT CRADLE</p>  <p>2Slot Cradle SM2X-2CRD-C00 USB Type-C: For charging</p>	 <p>SMXX-PWSP-CXX USB Type-C Charging Power Supply</p>	 <p>Pocket Cradle Type1 and Type2 SM2X-POCK-C00</p> <p>Pocket Type 1 : * Pocket for booted devices</p> <p>Pocket Type 2: * Pocket for non-booted devices</p>	 <p>SX2X-BOOT-01</p>	 <p>Hand Strap (-S01/10/50) SX2X-STRP-S01/10/50</p>
<p>8 SLOT CRADLE</p>  <p>8Slot Cradle SM2X-8CRD-C00</p> <ul style="list-style-type: none"> DIN JACK: Dedicated power input for device charging 	 <p>SMXX-PWSP-8XX DIN Jack Power Supply</p>	<p>Battery</p>  <p>Battery(4,000mAh) SX2X-BATT-S40</p>  <p>Battery(6,000mAh) SX2X-BATT-E60 Coming Soon</p>	<p>Trigger</p>  <p>SX2X-TRIG-S00</p>	 <p>Bullet proof Screen Protector SX2X-SCPR</p>

Cradle / Charging

2-Slot Fast charging only cradle

SM2X-2CRD-C00



I/O USB C Type



Input 9VDC / 3A



Dimension 112.5 x 156 x 63mm



Weight 320g

Compatible

Right angle

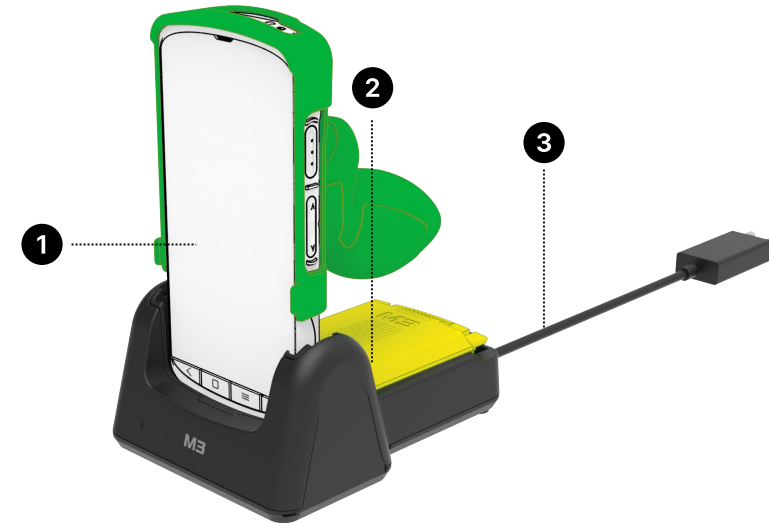

❶ SM25/24

SM250E-W2CFSS-HF / SM250E-WFCFSS-HF
SM255E-W2CFSS-HF / SM255E-WFCFSS-HF

SM240E-W2CHSS-HF / SM244E-W2CHSS-HF

❷ Battery

SX2X-BATT-S40

❸ Power Supply





SMXX-PWSP-CXX

Cradle / Charging

8-Slot charging only cradle

SM2X-8CRD-C00



	I/O	DIN Jack
	Input	12VDC / 10A
	Dimension	450 x 156 x 80 mm
	Weight	760g

Compatible

Right angle

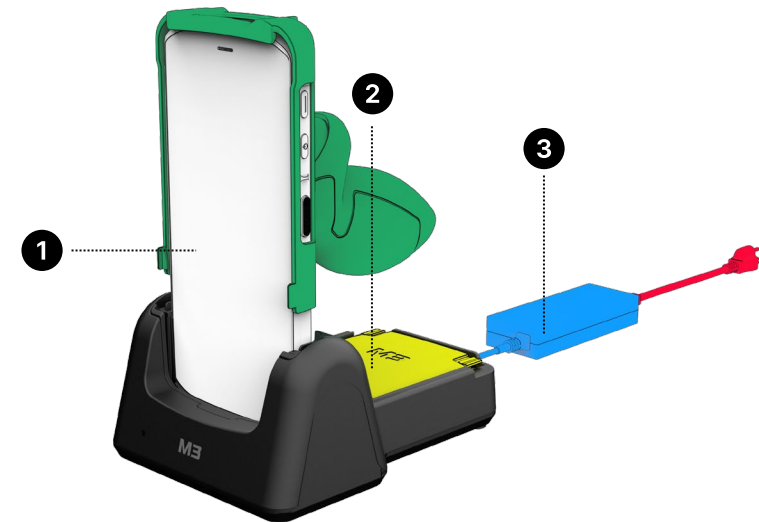

- 1 SM25/24** SM250E-W2CFSS-HF / SM250E-WFCFSS-HF
SM255E-W2CFSS-HF / SM255E-WFCFSS-HF
SM240E-W2CHSS-HF / SM244E-W2CHSS-HF
- 2 Battery** SX2X-BATT-S40
- 3 Power Supply** SMXX-PWSP-8XX

Cradle Configuration



2/8 Slot Cradle

SM2X-2CRD-C00
SM2X-8CRD-C00



Base Cradle

Depending on the installed pocket cradle,
the corresponding device can be docked and charged.



SM24/25 Pocket 1

* Pocket for booted devices



SM24/25 Pocket 2

• Pocket for non-booted devices

SM30 Pock Cradle (SM3X-POCK-C00)

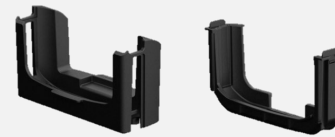

SM24/25
Pocket 1
Pocket for
booted devices

SM24/25
Pocket 2
Pocket for
non-booted
devices

By installing the SM30 pocket cradle on the
base cradle, SM30 devices can be docked
and charged.

* Future devices will also be compatible with
SM30/SM24/SM25 cradles through pocket cradle
replacement.



For 1/8-slot cradle orders, Pocket 1 is securely screw-mounted to the cradle base prior to shipment, and Pocket 2 is also provided in an assembled state.

Power Supply / Charging

PDA Adaptor Power supply

SMXX-PWSP-CXX

Fast Charging



Input 100~240VAC



Output 9VDC / 3A

Compatible



SM25

SM250E-W2CFSS-HF
SM250E-WFCFSS-HF
SM255E-W2CFSS-HF
SM255E-WFCFSS-HF

SM24

SM240E-W2CHSS-HF
SM244E-W2CHSS-HF



2Slot Cradle

(SM2X-2CRD-C00)

Depending on the type of connector at the end

SMXX-PWSP-CEU/KR/US/UK

Power Supply / Charging

Power Supply for 8 slot cradle

SMXX-PWSP-8XX



Compatible



8 Slot Cradle
(SM2X-8CRD-C00)

Depending on the type of connector at the end

SMXX-PWSP-8EU/KR/US/UK



Input 100~240VAC



Output 12VDC / 10A

Pocket Cradle

Pocket Cradle - Type1 and Type2 Set

SM2X-POCK-C00

Compatible



Pocket 1

* Pocket for booted devices



Pocket 2

• Pocket for non-booted devices

The Pocket cradle can be purchased separately and is **compatible with the SM30 as well as future SM/SL series cradle models**



Dimension

Pocket 1

90 x 50 x 20mm

Pocket2

85 x 45 x 20mm



Weight

30g

30g

How to use the 24/25 cradle with SM30 and future models

1 Removal of Pocket 2 Cradle

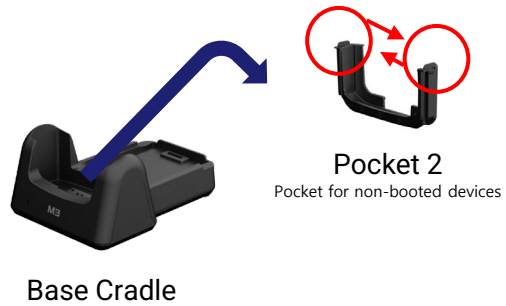

Hold both ends of the pocket marked with red circles, press inward, and remove the Pocket 2 cradle.

2 Removal of Pocket 1 Cradle

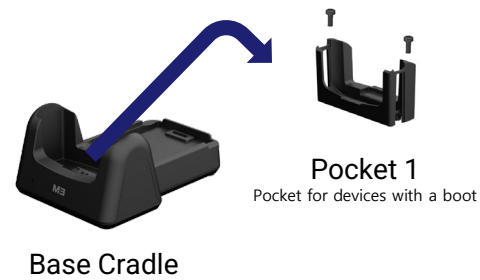

Remove the screw-mounted Pocket 1 cradle from the base cradle using a screwdriver.

3 Installation of the SM30 pocket cradle

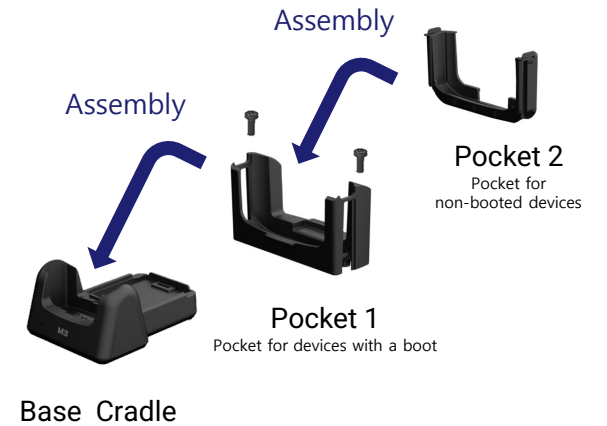

To dock and charge SM30 devices, install the SM3X-POCK-C00 cradle on the base cradle with the SM30 pocket cradle removed.

Step 1.

Secure Pocket 1 to the base cradle using screws.

Step 2. Install or remove Pocket 2 depending on whether the device has a boot attached.

*(With boot: install Pocket 2 /
Without boot: remove Pocket 2)*

* Future devices will also be designed to be compatible with the cradle using the same method.

BOOT

Rubber boot SM25/24

SX2X-BOOT-01



Dimension 172.5 x 87 x 30.8mm



Weight 120g

Compatible



SM25

SM250E-W2CFSS-HF
SM250E-WFCFSS-HF
SM255E-W2CFSS-HF
SM255E-WFCFSS-HF

SM24

SM240E-W2CHSS-HF
SM244E-W2CHSS-HF

Guidelines for Using the Cradle While the Device is Equipped with Boots

#1 Cradle Charging Guide for Devices with Boots Attached



! When charging the device with the boot (protective cover) attached, please remove Pocket 2 from the cradle first.

Guidelines for Using the Cradle While the Device is Equipped with Boots

#2 Cradle Charging Guide Without Boots Attached



- ! When the boot (protective cover) is not attached, charge the device with Pocket 2 assembled to Pocket 1 and the main cradle.
>The product is provided fully assembled and ready for immediate use.

Trigger

Trigger Handle for SM30

SX2X-TRIG-S00



Dimension 85x 138.7 x 165mm



Weight 120g

Compatible



SM25

SM250E-W2CFSS-HF
SM250E-WFCFSS-HF
SM255E-W2CFSS-HF
SM255E-WFCFSS-HF

SM24

SM240E-W2CHSS-HF
SM244E-W2CHSS-HF

Trigger

Precautions for Attaching the Device to the Trigger Handle

✗ DON'T



Unable to Mount the Device on the Trigger Handle

Devices with boots attached cannot be mounted on the trigger handle.

✓ DO



Condition for Attaching the Device to the Trigger Handle

The device can only be mounted on the trigger handle after removing the boots.

Trigger

Cradle Charging Instructions with Trigger Handle Attached



When charging a trigger handle–mounted device without a protective boot, both of the following pockets must be installed inside the main cradle :

- Pocket 1 (Booted Device)
- Pocket 2 (Non-Booted Device)



*** For 2/8-slot cradle orders, Pocket 1 is securely screw-mounted to the cradle base prior to shipment.

*** The product is provided fully assembled and ready for immediate use.

Battery

SM25/24 Battery

SX2X-BATT-S40



Dimension 6.9 x 8.5 x 1cm



Weight 93.4g

SX2X-BATT-E60 Coming Soon



Dimension -



Weight -

ETC. / Miscellaneous

ETC.



SX2X-STRP-S01/10/50
Hand Strap for SM24/25
(-01/10/50 pcs)



SX2X-SCPR
Bullet proof Screen Protector